

CPFUMC SOUND BOOTH CONSTRUCTION DETAILS

Scale: 1 in = 1 ft
nmh 13Jun2020 Rev. K

NOTES

1. All exposed 3/4" plywood edges to be covered with PVC moulding.
2. Carpet tiles to be trimmed and laid on top of MDF floor.
3. Holes in Shelf are 2.0" diam typ.
4. Holes in Desktop are 2.0" diam. typ.
5. MDF floor segments near front (west) end are to be trimmed so that they are removable - not fastened to platform to allow for easier cable routing.
6. Platform 2"x8" support modules are 48"x 47.25" outside dimension screwed or bolted together.
7. Platform modules against the Sanctuary E wall will have 3.0" diam. access holes drilled for cable routing coming from the adjacent wall.
8. See Sound Booth Equipment Layout for approximate locations of holes in Desktop and Shelf.
9. Steel angle brackets to secure center desktop support to 4" support board and platform.

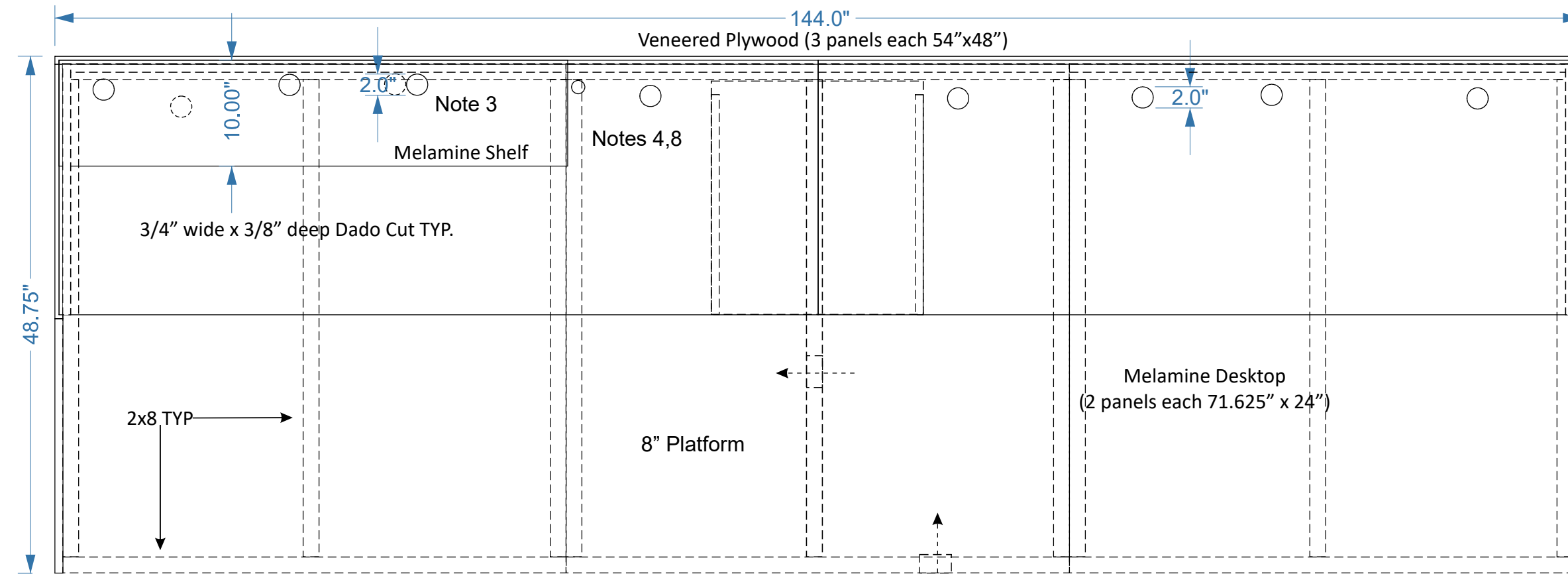

PLAN

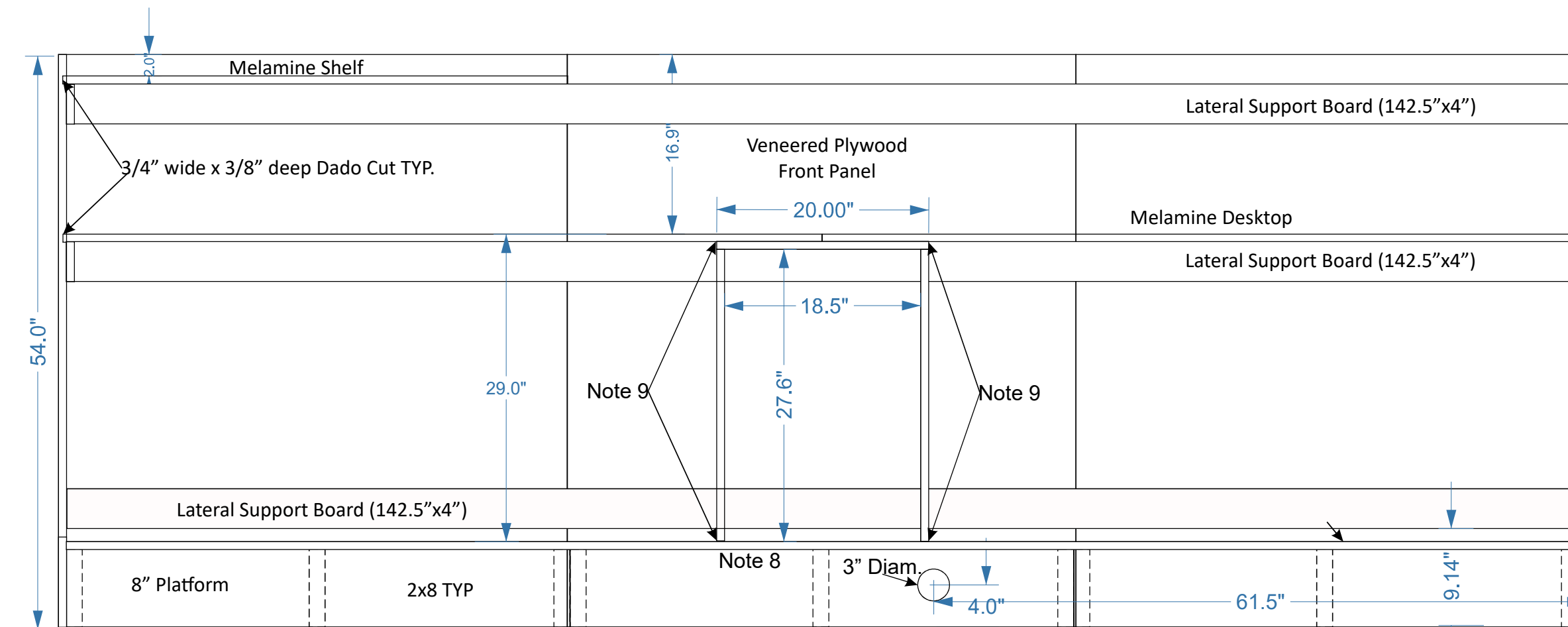

REAR ELEVATION

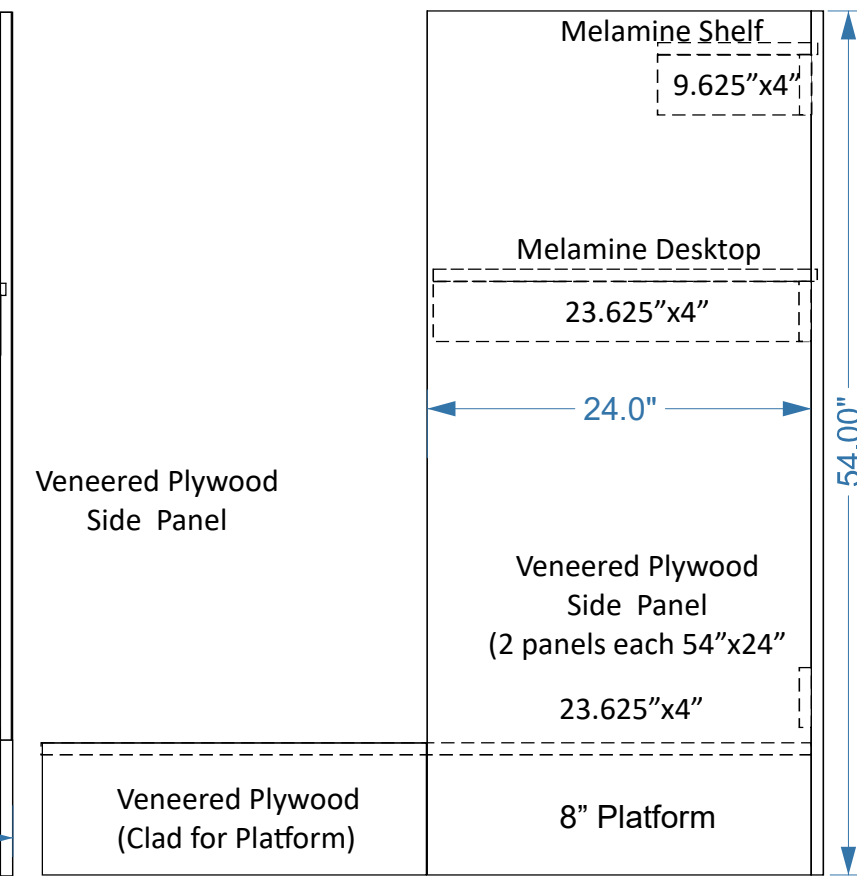

SIDE